

Summer

2026

Program



More Than a Visit—It's Steep Rock.

NW 2-29-10W, Steep Rock, MB

JUNE

Weekends

June 5 | Friday | 7:00 - 9:00 PM

50/50 & Chase the Ace (Pavilion)

June 7 | Sunday | 10:00 AM

Steep Rock Trail Trot Starts at the Pavilion

5km/10km Trail Walk/Run

**Golf Carts 11:00 AM start time*

June 12 | Friday | 7:00 - 9:00 PM

50/50 & Chase the Ace (Pavilion)

June 13 | Saturday | 9:00 AM

Walk & Talk Social Group (Park Store)

June 19 | Friday | 7:00 - 9:00 PM

50/50 & Chase the Ace (Pavilion)

June 20 | Saturday | 9:00 AM

Walk & Talk Social Group (Park Store)

June 21 | Sunday | 10:00 AM

Summer Solstice Fishing Derby

\$10 Entry (Park Marina)

June 26 | Friday | 7:00 - 9:00 PM

50/50 & Chase the Ace (Pavilion)

June 27 | Saturday | 9:00 AM

Walk & Talk Social Group (Park Store)

Manitoba Made Meat Draw - 4:00 PM (Shoreline)

Lakeside Live 4:00- 7:00 PM (Shoreline)

JULY

Weekends

July 3 | Friday | 7:00 - 9:00 PM

50/50 & Chase the Ace (Pavilion)

"JULY LONG"

July 4 | Saturday | ALL DAY

Walk & Talk Social Group 9:00 AM

Canada Day Parade 12:00 PM (starting at the Pavilion)

Pavillion Dinner 6:00 PM

Band 7:00 PM & Fireworks at Dusk

July 5 | Sunday | 10:00 AM

The Tee Box Classic

July 10 | Friday | 7:00 - 9:00 PM

50/50 & Chase the Ace (Pavilion)

July 11 | Saturday | ALL DAY

Walk & Talk Social Group 9:00 AM (Park Store)

Manitoba Made Meat Draw 4:00 PM (The Shoreline)

Lakeside Live 4:00 - 7:00 PM (The Shoreline)

July 12 | Sunday | ALL DAY

Story Book Walk- Park Wide (Map Provided)

July 17 | Friday | 7:00 - 9:00 PM

50/50 & Chase the Ace (Pavilion)

Christmas in the Park: Camper's Edition

July 18 | Saturday | ALL DAY

Walk & Talk Social Group (Park Store)

Christmas Poker Derby 1:00 - 3:00 PM

Karaoke 7:00 PM (The Shoreline)

Christmas Lights & Decorating Contest

July 19 | Sunday | 10:00 AM

Kids Christmas Scavenger Hunt (Park Store)

July 24 | Friday | 7:00 - 9:00 PM

50/50 & Chase the Ace (Pavilion)

July 25 | Saturday | 9:00 AM

Walk & Talk Social Group

AUGUST **Weekends**

AUGUST LONG

July 31 | Friday | 7:00 - 9:00 PM

50/50 & Chase the Ace (Pavilion)

August 1 | Saturday | ALL DAY

Walk & Talk Social Group 9:00 AM

Cornhole Tournament 11:00 AM (Pavilion)

Pavillion Dinner 6:00 PM

Band 7:00 PM & Fireworks at Dusk

August 2 | Sunday | 10:00 AM

Story Book Walk - Park Wide (Map Provided)

Sunset Karaoke 7:00 PM (The Shoreline)

August 7 | Friday | 7:00 - 9:00 PM

50/50 & Chase the Ace (Pavilion)

August 8 | Saturday | ALL DAY

Walk & Talk Social Group (Park Store)

Manitoba Made Meat Draw - 4:00 PM (Shoreline)

Lakeside Live 4:00- 7:00 PM (Shoreline)

August 14 | Friday | 7:00 - 9:00 PM

50/50 & Chase the Ace (Pavilion)

Aug 15 | Saturday | ALL DAY

Poker Derby 1:00 - 3:00 PM

Lakeside Live 4:00 - 7:00 PM

August 16 | Sunday | 10:00 AM

Sandcastle Building Competition (Main Beach)

August

Continued...

August 21 | Friday | 7:00 - 9:00 PM
50/50 & Chase the Ace (Pavilion)

August 22 | Saturday | ALL DAY
Walk & Talk Social Group 9:00 AM
FROM HERE FEST 1:00 - 11:00 PM
Halloween in the Park 3:00 PM (Map Provided)

August 28 | Friday | 7:00 - 9:00 PM
50/50 & Chase the Ace (Pavilion)

August 29 | Saturday | ALL DAY
Walk & Talk Social Group (Park Store)
Lakeside Live 4:00- 7:00 PM (Shoreline)

August 30 | Sunday | 7:00 - 9:00 PM
Story Book Walk Park Wide - (Map Provided)

September

Weekends

September 4 | Friday | 7:00 - 9:00 PM
50/50 & Chase the Ace (Pavilion)

September 5 | Saturday | ALL DAY
Walk & Talk Social Group 9:00 AM
Itty Bitty Bash 6:00 PM

September 6 | Sunday | 7:00 - 11:00 PM
Sunset Karaoke

WE HAVE Delivery!

**SCAN
ME!**



Shoreline Delivery Has Arrived

Enjoy the convenience of ordering your favourite menu items right from your site.

Scan the QR code below to place your order online.

New: Friday Night Pavilion Delivery

Join us every Friday for Pavilion delivery featuring an exclusive Friday night menu with brand new items.

Fridays: 5:00 PM - 8:30 PM

(Pavilion & Park Delivery)

Saturdays: 4:00 PM - 8:00 PM

**Hours may expand throughout the summer. Check our Facebook page!*

RESTAURANT Hours

MAY & JUNE

Friday: 5:00 PM - 8:30 PM

Saturday: 11:30 AM - 8:30 PM

Sunday: 11:30 AM - 6:00 PM

JULY & AUGUST

Tuesday - Saturday: 11:30 - 8:30 PM

Sunday: 11:30 AM - 6:00 PM

**Closed Mondays*

- Long weekends - Closed on Tuesday.
- Hours may be extended during special events.
- Scan the code on the back page to read about Lakeside Live patio performers.
- **Grill shuts off 15 minutes before closing.**

KEEP STEEP ROCK

Safe & Enjoyable

SPEED LIMIT

A maximum speed of 15 km/h is enforced throughout the park at all times.

QUIET TIME

Quiet hours begin at 11:00 PM to 9:00 AM. Please be respectful of fellow campers and keep noise to a minimum.

MOTORIZED VEHICLES

All operators of motorized vehicles, including ATVs and dirt bikes, must hold a valid driver's licence.

ACTIVE RAILS TRAIL

ATVs are not permitted on the new Steep Rock Active Rails Trail.

It's your trail. Protect it.

STORE Hours

MAY & JUNE

9:00 AM - 5:00 PM - 7 DAYS A WEEK

JULY & AUGUST

9:00 AM - 9:00 PM - 7 DAYS A WEEK

SEPTEMBER -

9:00 AM - 5:00 PM - 7 DAYS A WEEK

***GATE LOCKED ON OCTOBER 15TH**

Event Description

Get detailed event descriptions, registration information, volunteer opportunities, and everything you need to know before you go. Some events require a little more than a headline. This is where the full experience comes to life.



**SCAN
ME!**





STEEP ROCK BEACH PARK
 Address NW 2-29-10W
 204-449-2221

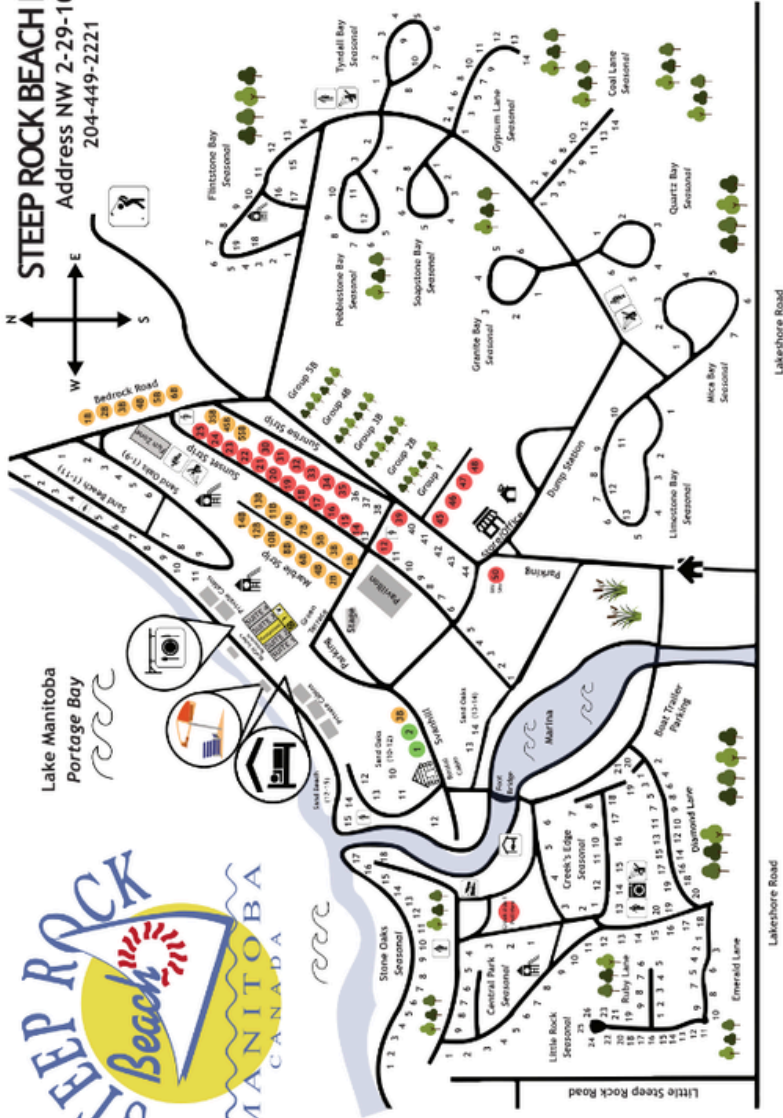

- LEGEND**
- Store/Office
 - Bathrooms
 - Showers
 - Restuarant
 - Beach Suites
 - Gate House
 - Laundry
 - Boat Launch
 - Beach
 - Driving Range
 - Regular Basic Site
 - 30 amp site w/water & Sewer
 - 30 amp site w/water
 - Seasonal Site
 - Dog Kennels
 - Fish Station
 - Playground

Steep Rock Trails Map

Last year the Campground and Steep Rock Cottage Owners Assoc. worked together to build the trail from the campground to the quarry so everyone can safely travel around Steep Rock and enjoy its beauty. Please allow only foot traffic, bicycles and golf carts on the path and help keep it clean and safe for all of us.

 Pedestrian Only

 Pedestrian and Golf Carts

 ATV and General Use

 Parking

 Washrooms



SPBP Emergency &

Safety Information

In the event of an emergency, **call 911 first**, then notify Park Management at 204-768-0500, or if there is no answer, call 204-449-2221 (SRBP Office). **The AED machine is located in the Park Store.**
Park Address: Steep Rock Beach Park, NW 2-29-10W, Steep Rock, Manitoba

WATER SAFETY

- Lake Manitoba conditions can change quickly. Calm water near the shoreline does not mean conditions are safe farther out.
- Strong winds and currents can carry swimmers and inflatables away from shore very quickly.
- If conditions are windy, avoid using inflatables, floaties, and air mattresses on the lake.
- Children should always be supervised near the beach, marina, and docks.
- Life jackets are strongly recommended for all watercraft users, including kayaks, paddle boards, and boats.
- Stay inside marked buoy zones whenever possible.
- Alcohol and water activities are a dangerous combination.

FIRE SAFETY

- Never leave campfires unattended.
- Keep propane appliances and fire pits a safe distance from trailers, trees, and structures.
- Fire bans will be posted at the entrance gate, at the store, and on the park's social media pages.

CAMPGROUND & COMMUNITY SAFETY

- Dogs must be on a leash at all times. Please clean up after your pets.
- Active Trails are shared-use spaces. Help keep them safe and enjoyable for everyone. NO ATV's or Side by Sides ALLOWED
- Severe weather can move in quickly. Secure umbrellas, tents, canopies, and loose items during windy conditions.
- Report unsafe behaviour, damaged infrastructure, or hazards to Park Management as soon as possible.

Let's Connect



204 449 2221
Office | May-September



204 768 0050
Diane | Park Manager



www.steeprockbeach.ca



steeprockbeachpark@gmail.com
Management



officesrbp@steeprockbeach.ca
Accounting



board@steeprockbeach.ca
Board of Directors



info@grahamdale.ca
R.M of Grahamdale



431 253 3663 - The Shoreline
playatsteeprock@gmail.com
The Shoreline - Facebook